

Solar Wall Lights



Introduction

Solar lights work by using electricity generated by the solar panel to charge internal batteries. These batteries are then used to power the light. The lights automatically illuminate at night by using a sensor. The duration of illumination will depend on the amount of sunlight and therefore charge received by the batteries.

Contents

A • Wall Light Housing* x4

B • Solar Panel x4

C • Wall Anchors x8

D • Screws x8

*size/shape/color may vary

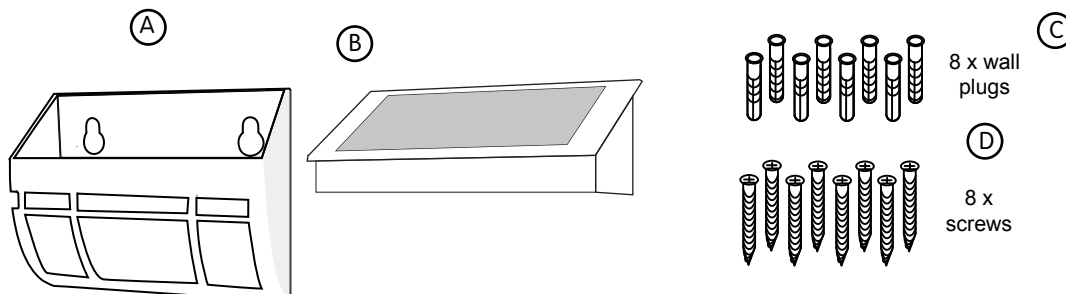

Position

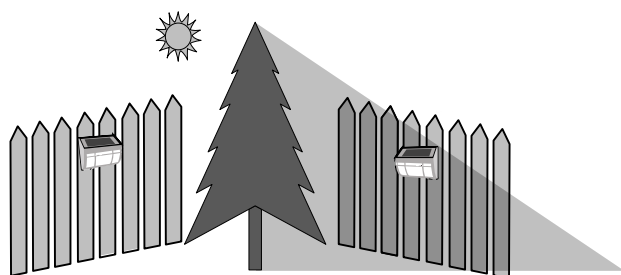

Position the light to receive the maximum amount of sunlight.

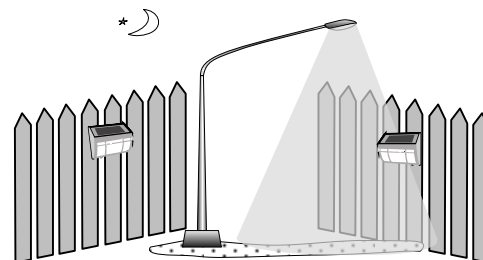

Do not position under bright light as this will prevent the light switching on at night.

Use

Although there may be some charge left in the battery we recommend fully charging it before first use. Remove the battery pull tab on the bottom of the solar panel and place in sunny location for a day to ensure the battery is fully charged. Once fully charged install the light in desired location. The light will now automatically illuminate when it gets dark. You can cover the solar panel to test that the light is operating.

Battery

Rechargeable batteries become less efficient with repeated charge-discharge cycles and the battery capacity reduces. If you find that the battery appears to be less efficient or does not run for long we suggest you first try to boost charge it. Place the light in strong direct sunshine for a day to allow the maximum charge to the battery. If after this boost charge your battery still does not perform to expectations you should replace it. To change the battery remove the 4 screws on the underside of the solar top to remove the battery cover.

Remove the existing battery and replace with a new one. Only use Ni-MH or Ni-Cd rechargeable batteries. Please ensure that the battery is disposed of according to local regulations.

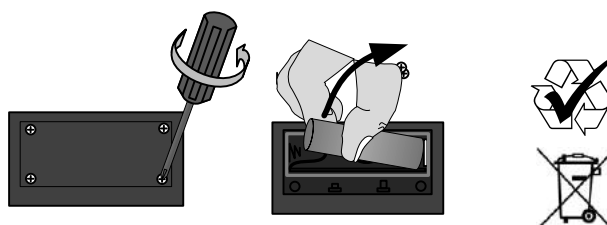

Customer Service

For immediate answers visit our website www.smartlivinghg.com where you will find troubleshooting and FAQs or contact us using the details below. One year limited manufacturer's warranty.



Installation

- Determine where the the product is to be mounted, and use one of the following methods to install.
- **If using adhesive strips to adhere lights to vinyl siding:** wipe clean the mounting location first. Apply adhesive strips to the back of the wall light housing and apply to the desired location. Press firmly against the back of the housing to ensure it sticks securely to the surface.
- **If mounting with screws and wall anchors:** Using a pen or marker, mark the screw holes to be drilled on the wall by using the wall light housing as your guide. Drill holes in wall where the screw holes have been marked. Install the wall anchors into wall using a hammer to tap them in until they are flush with the wall. Fit the screws into the wall anchors and tighten leaving enough of the screw head showing to mount the wall light housing to them.
- **If no wall anchors are needed:** simply install the screws directly in surface leaving enough of the screw head showing to mount the wall light housing to them.
- Slide the holes on the wall light housing over the screw heads and push down to lock the wall light housing in place. Slide the solar panel into the top of the wall light housing.

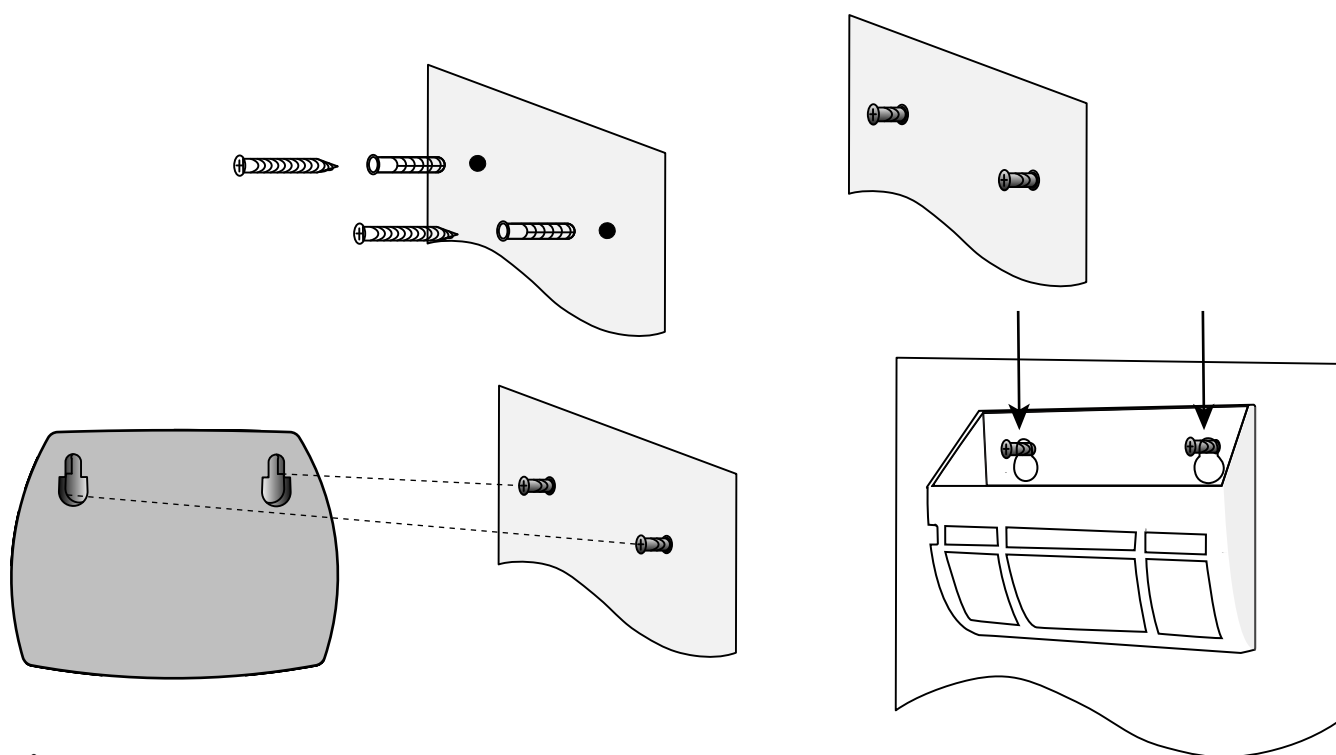

Maintenance

Clean the panel using water or glass cleaner. Do not use an abrasive sponge on panel surface.

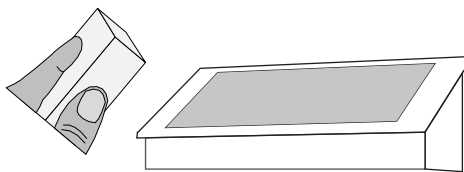

Customer Service

For immediate answers visit our website www.smartlivinghg.com where you will find troubleshooting and FAQs or contact us using the details below. One year limited manufacturer's warranty.

Smart Solar is a Smart Living Home & Garden brand © 2016.1

Telephone: + 1 813 343 5775

Email: customerservice@smartlivinghg.com

Web: www.smartlivinghg.com

Smart Living Home & Garden

